

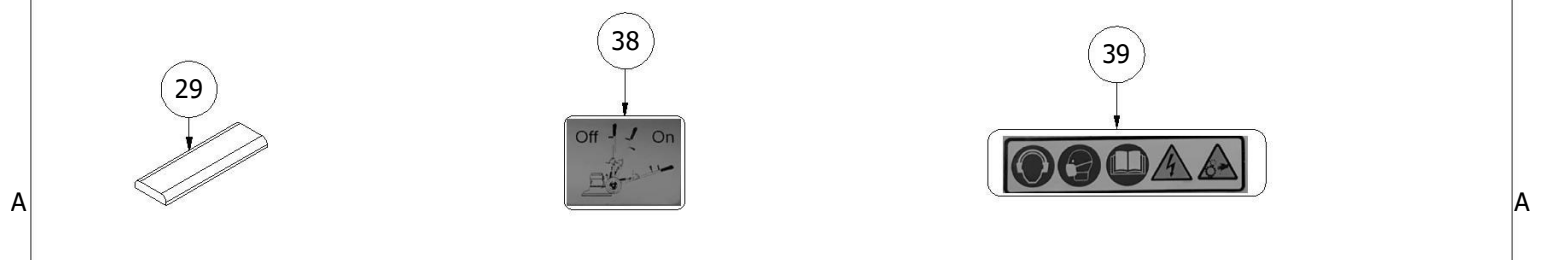

	P/N machine: AMO310002	Page: 1	
	Description: FLEXISAND 1900W 230V/50HZ	Edition: 2022	

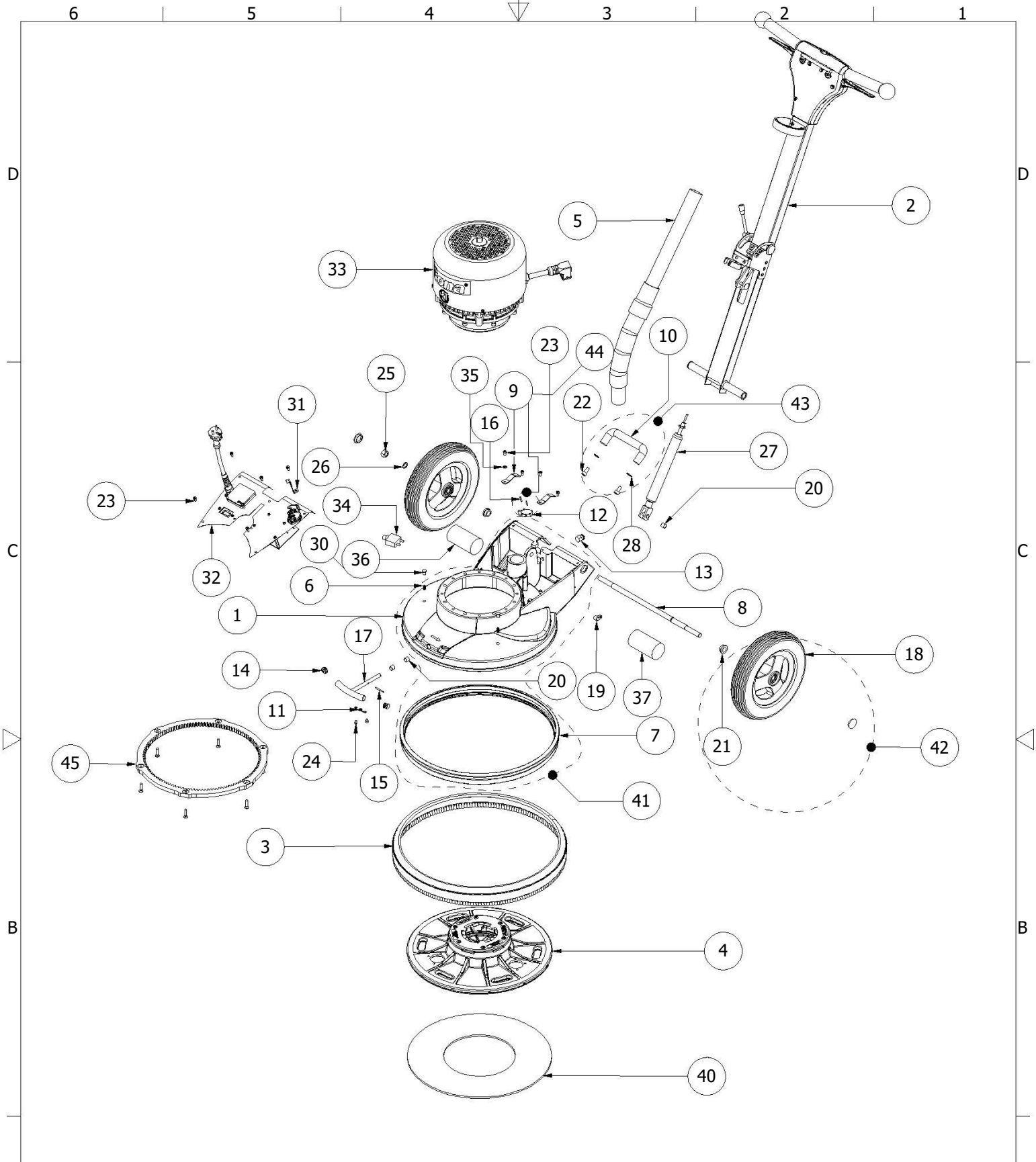

	P/N machine:	AMO310002	Page:	2A	
	Description:	FLEXISAND 1900W 230V/50HZ	Edition:	2022	

SPARE PARTS				SPARE PARTS			
ITEM	P/N	DESCRIPTION	QTY	ITEM	P/N	DESCRIPTION	QTY
1	ASO311001.3	FREILACKE GREY BED-FLEXISAND	1	24	ASO958009	SCREW M4X6 LOW HEAD MERLT	2
2	ASO316500	COMPLETE FOLDING HANDLE-FLEXISAND	1	25	ASO960070	NUT ML6M M12 GALVANIZED	2
3	ASO312102	DUST SKIRT FOR SANDING DISC-FLEXIS	1	26	ASO968206	SHIM 12X18X1	2
4	ASO312501	PAD DRIVE DISC 16"	1	27	ASK3199948101	GAS SPRING ASSEMBLY-FLEXISAND	1
5	ASO316600	COMPLETE SUCTION PIPE	1	28	ASK5802230004	WASHER 8.4x16X1.6 UNI6592 GALVANIZ.	2
6	ASO947518	HELI-COIL M8X1.25X12	2	29	ASK3100030471	CABLE GUARD PLASTIC STRIP 40MM	1
7	ASO311002	RUBBER BUMPER-FLEXISAND	1	30	ASK3100030805	SNAP FIT BLACK PLUG-FLEXISAND BED	2
8	ASO311004	HANDLE SHAFT-FLEXISAND	1	31	ASK3100030710	MOTOR PLUG SAFETY PLATE	1
9	ASO311010	PLASTIC CLAMP FOR CAPACITOR	2	32	ASK3199940021	START.EQUIPMENT 1900W 230/50+SOCKET	1
10	ASO945129	BLACK LIFTING HANDLE	1	33	ASK3199943521	COMPL.RATIO-MOTOR+PLUG-1900W 230/50	1
11	ASO311018	TORSION SPRING SF-VFR7082	1	34	ASK5299940095	TH.OVERL.CIRC.BREAKER 16A-ETA(1658)	1
12	ASO319911	MICRO SWITCH D3V-162-1C5	1	35	ASK5802233002	INT.SERR.LOCK WASHER D5 DIN6798/J G	1
13	ASO903992	CABLE GUARD GLAND M12X1.5	1	36	ASK3100030328	CAPACITOR 50MF FLEXI 1900W 50/60HZ	1
14	ASO929086	BLACK STOPPER 16/13-8	2	37	ASK4600030119	START CAPACITOR 145-174 MF/330V	1
15	ASO935332	CYLINDRICAL PIN D.3X32 (M6)	1	38	ASO996412	HANDLE TILT WARNING LABEL	1
16	ASO936118	SPRING PIN FRP 3X18	2	39	ASO996106	N.5 WARNING SYMBOL LABEL	1
17	ASO311016	LIFTING HANDLE-FLEXISAND	1	40	ASO312007	RUBBER PLATE FOR SANDING PAPER	1
18	ASO945390	WHEEL R250-50-2-E-S-K	2	41	ASO311050	MACHINE BED,RUBB.BUMPER INCL.-FLEXI	1
19	ASO945740	CABLE FIXING CLIP	1	42	ASO319915	WHEELS AND NUTS PAIR-FLEXISAND	1
20	ASO948810	TEFLON BUSHING-10/12X10 B	3	43	ASO319910	BACK HANDLE SET	1
21	ASO948425	FLANGED BUSHING-2992 JF14X10	2	44	ASO319911	HANDLE TILT MICRO SWITCH ASSEMBLY	1
22	ASO952516	SCREW M8X16 HEX.SOCK.END CAP GALV.	2	45	ASK3199940082	INTERN.GEAR+6 TORX SCREWS M6X25-PD	1
23	ASO957913	SCREW M5X10 TORX CAP HE.TT DIN7500C	11				

	P/N machine: AMO310002	Page: 2B	
	Description: FLEXISAND 1900W 230V/50HZ	Edition: 2022	

ASO316500 - COMPLETE FOLDING HANDLE-FLEXISAND

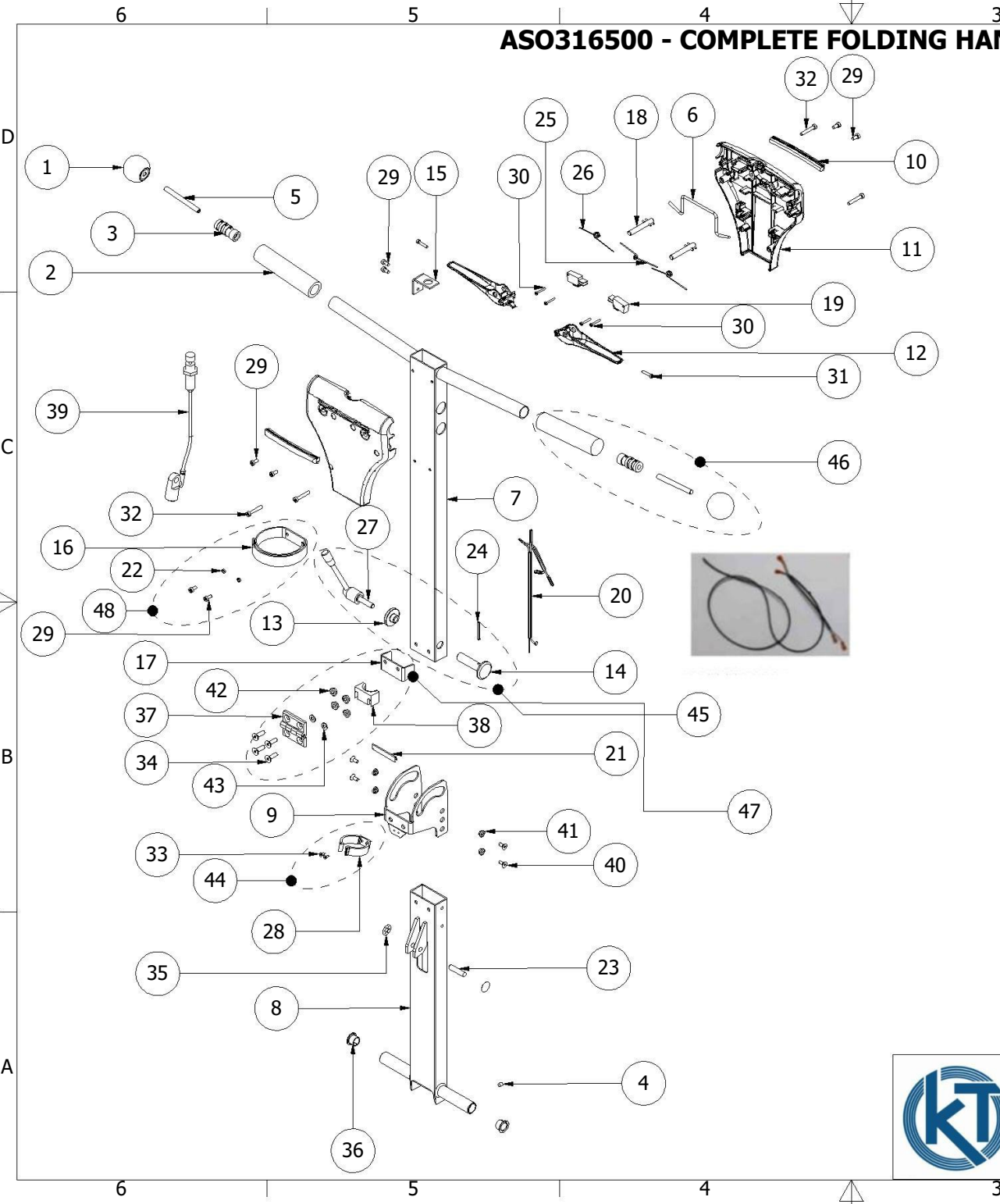

ITEM (39) ASK3199948102 - GAS SPR. UPPER HOOKING ASSEMBLY-FLEX

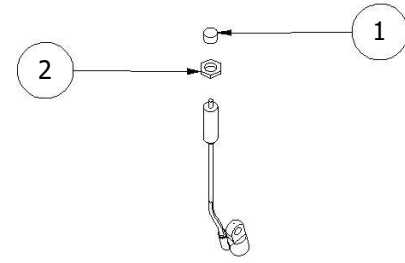

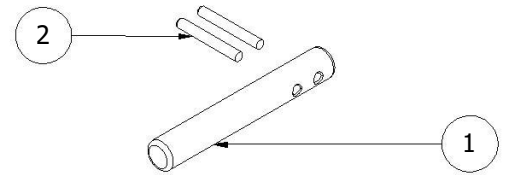

SPARE PARTS			
ITEM	P/N	DESCRIPTION	QTY
1	ASK3100030450	HANDLE RELEASE BUTTON 18.5X10XM6	1
2	ASK3100030451	NUT M16X1.5X5 FOR HYDRAULIC RELEASE	1

ITEM (18) ASO316504 - COMPL.ACCIDENT.START LOCKING BUTTON





SPARE PARTS			
ITEM	P/N	DESCRIPTION	QTY
1	ASO316004	START LOCK BUTTON PIN	1
2	ASO936935	PIN FRP 2.5X20	2

	P/N machine:	AMO310002	Page:	3A
	Description:	FLEXISAND 1900W 230V/50HZ	Edition:	2022



ASO316500 - COMPLETE FOLDING HANDLE-FLEXISAND

SPARE PARTS				SPARE PARTS			
ITEM	P/N	DESCRIPTION	QTY	ITEM	P/N	DESCRIPTION	QTY
1	ASO316026	HANDLE MACHINED KNOB D45	2	25	ASO942112	STARTING LEVER CENTRAL SPRING	1
2	ASO945580	HANDLE HANDGRIPS (PAIR)	1	26	ASO942305	STARTING LEVER SPRING	2
3	ASO945582	HANDLE RAWLPLUG	2	27	ASO945172	HANDLE ADJUSTMENT LEVER	1
4	ASO956412	GRUB SCREW M6X8-POINTED-ROUGH STEEL	1	28	ASO945566	PIPE HOOKING SPRING-VHA 51-60	1
5	ASO958708	THREADED PIN M8X80 GALVANIZED	2	29	ASO957913	SCREW M5X10 TORX CAP HE.TT DIN7500C	8
6	ASO311006	START LEVER LOCKING BRACKET	1	30	ASO957932	SCREW K30X20 TORX CAP HEAD WN1452	4
7	ASO316001	HANDLE UPPER FRAME	1	31	ASO957942	SCREW K40X20 TORX CAP HEAD WN1452	2
8	ASO316002	HANDLE LOWER FRAME-FLEXISAND	1	32	ASO957953	SCREW PT50X30 TORX CAP HEAD WN5452	4
9	ASO316002.C	HANDLE LOW.FRAME CONNECT.BRACKET-F	1	33	ASO958120	SCREW M3X8 TORX COUNTERSUNK HEAD	2
10	ASO316005	GUARD RUBBER	2	34	ASO958352	SCREW M6X20 MFT-TORX T30 GALVANIZED	4
11	ASO316011	HANDLE SHELL-FLEXISAND	2	35	ASO967300	LOCK WASHER 8X19X0.25/6	2
12	ASO316012	START LEVER-FLEXISAND	2	36	ASK3100030456	FLANGED BUSHING PTFE 14/16x22 L.12	2
13	ASO316014	HANDLE TIGHTENING FLANGE	1	37	ASK3100030470	STAINL.STEEL HINGE CMM-SST-50-SH-6	1
14	ASO316016	HANDLE TIGHTENING BOLT	1	38	ASK3100030472	CABLE PROTECTIVE BLOCK 38MM	1
15	ASO316017	HANDLE RELEASE BUTTON SUPPORT	1	39	ASK3199948102	GAS SPR.UPPER HOOKING ASSEMBLY-FLEX	1
16	ASO316020	VELCRO LOCK STRIP 400X20	1	40	ASK5801630512	SCREW M5x12 FLANGED TORX LOW HEAD	4
17	ASO316025	HINGE SUPPORT BRACKET	1	41	ASK5801430014	NUT M5 LOW SELF-LOCKING ST.STEEL NUT	4
18	ASO316504	COMPL.ACCIDENT.START LOCKING BUTTON	2	42	ASK5801936001	M6 LOW SELF-LOCKING DIN985 WASHER	4
19	ASO903869	MICRO SWITCH D3V-16-1C5	2	43	ASK5802230003	6.4X12.5 UNI6592 GALVANIZED VACUUM	2
20	ASO319944	CABLE FOR HANDLE	1	44	ASO319923	PIPE HOOKING SPRING ASSEMBLY HANDLE	1
21	ASO929033	HANDLE JOINT GUARD RUBBER 10MM	1	45	ASO319917	LOCK ASSEMBLY	1
22	ASO929087	BLACK PLASTIC WASHER 07-2-5	2	46	ASO316505	HANDLE KNOB ASSEMBLY (PAIR)	1
23	ASO935535	CYLINDRICAL PIN 8X36	1	47	ASK3199940100	STAINL.ST.HINGE ASSEMBLY-FLEXISAND	1
24	ASO936135	SPRING PIN FRP 3X35	1	48	ASO319922	VELCRO + SCREWS	1

	P/N machine: AMO310002	Page: 3B	
	Description: FLEXISAND 1900W 230V/50HZ	Edition: 2022	

ASK3199940021 - START.EQUIPMENT 1900W 230/50+SOCKET

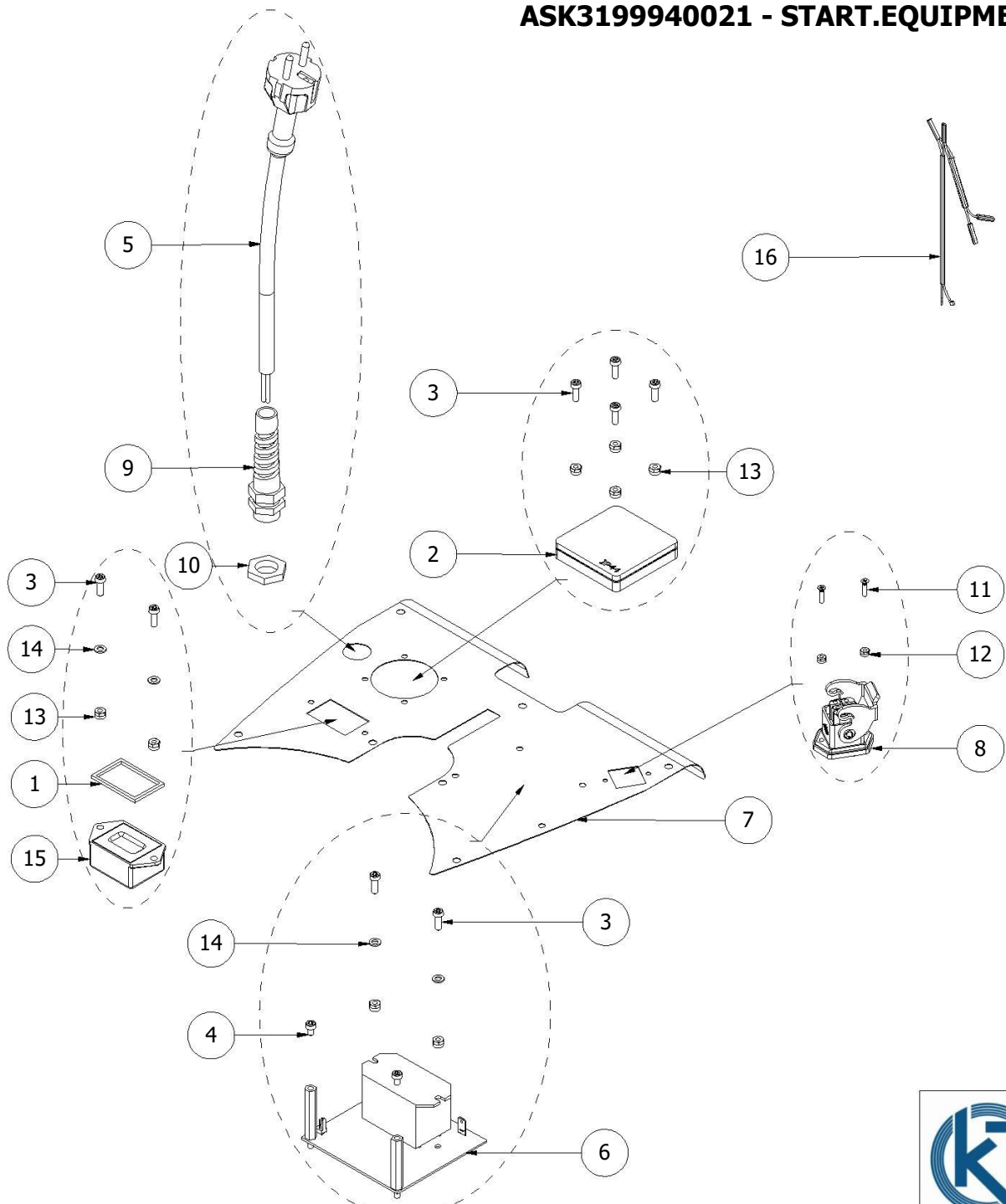

SPARE PARTS			
ITEM	P/N	DESCRIPTION	QTY
1	ASO115173	GASKET FOR HOUR METER	1
2	ASO903236	ELECTRICAL SOCKET 230V-2+1 POLES	1
3	ASO957807	SCREW M4X12 TORX CAP HEAD DIN7985 G	8
4	ASO957812	SCREW M4X6 TORX CAP HE.DIN7985 GAL.	2
5	ASK2600030030	CABLE 200MM+SCHUKO T/L/F	1
6	ASK3100030500	PRINTED CIRCUIT BOARD-SINGLE-2015-F	1
7	ASK3100030512	START.EQUIPM.PLATE F/SOCK.1900W50HZ	1
8	ASK4699930019	ASYNCHR.MOTOR COMPLETE SOCKET 4P+1	1
9	ASK5100030470	SPIRAL CABLE GREY GLAND PG11	1
10	ASK5100030474	GREY SPIR.CABLE GLAND RING NUT PG11	1
11	ASK5800530303	SCREW M3X12 CROSS REC.F.H.UNI7688 G	2
12	ASK5801933003	NUT M3 HIGH SELF-LOCK.GALVAN.DIN982	2
13	ASK5801933004	NUT M4 SELF-LOCKING GALVANIZ.DIN982	8
14	ASK5802230001	WASHER D4 GALVANIZED - FLAT	4
15	ASK7200030038	HOUR METER WITH DATA & INFO	1
16	ASO319944	CABLE FOR HANDLE	1



	P/N machine:	AMO310002	Page:	4
	Description:	FLEXISAND 1900W 230V/50HZ	Edition:	2022

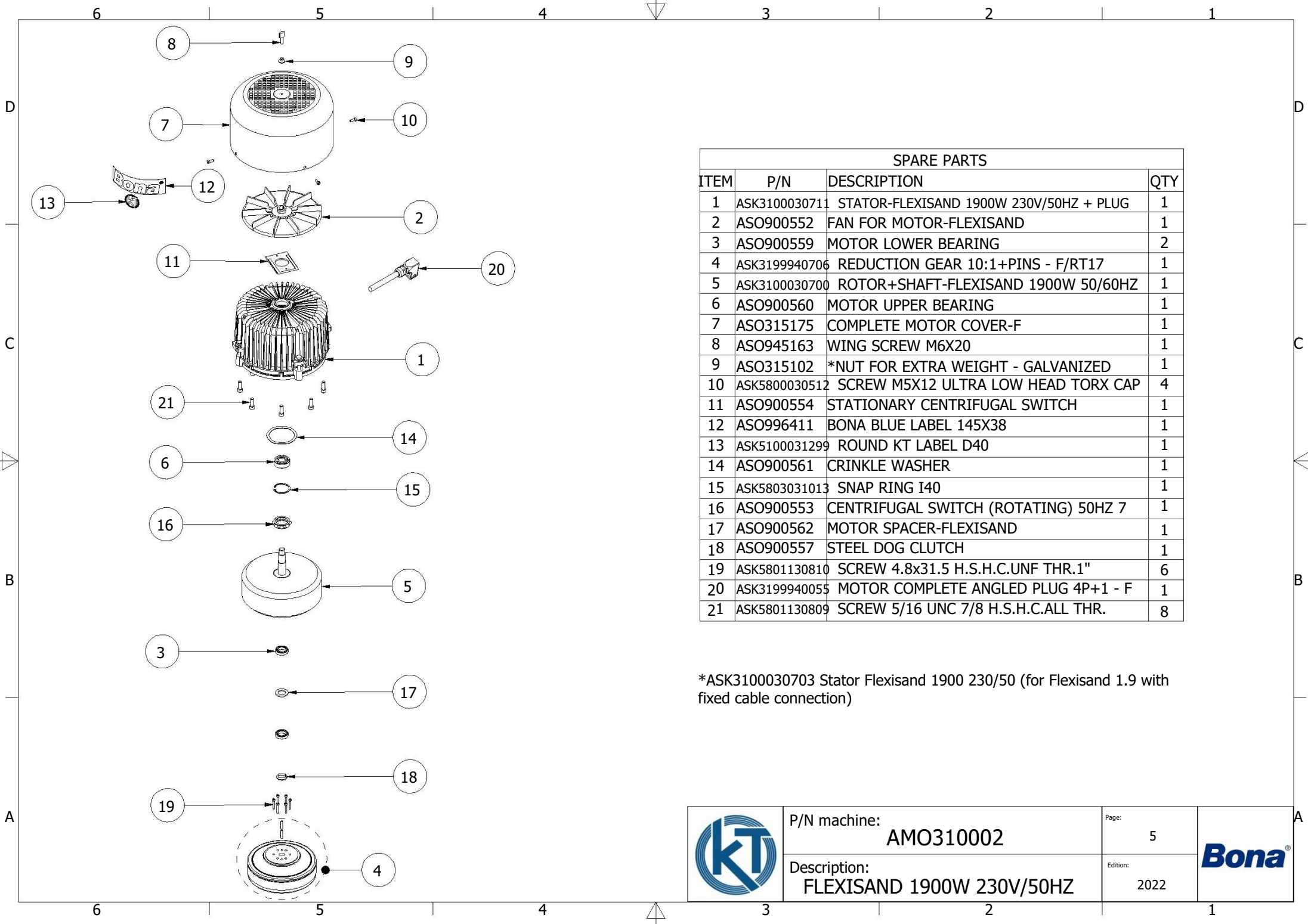



SPARE PARTS			
ITEM	P/N	DESCRIPTION	QTY
1	ASK3100030711	STATOR-FLEXISAND 1900W 230V/50HZ + PLUG	1
2	ASO900552	FAN FOR MOTOR-FLEXISAND	1
3	ASO900559	MOTOR LOWER BEARING	2
4	ASK3199940706	REDUCTION GEAR 10:1+PINS - F/RT17	1
5	ASK3100030700	ROTOR+SHAFT-FLEXISAND 1900W 50/60HZ	1
6	ASO900560	MOTOR UPPER BEARING	1
7	ASO315175	COMPLETE MOTOR COVER-F	1
8	ASO945163	WING SCREW M6X20	1
9	ASO315102	*NUT FOR EXTRA WEIGHT - GALVANIZED	1
10	ASK5800030512	SCREW M5X12 ULTRA LOW HEAD TORX CAP	4
11	ASO900554	STATIONARY CENTRIFUGAL SWITCH	1
12	ASO996411	BONA BLUE LABEL 145X38	1
13	ASK5100031299	ROUND KT LABEL D40	1
14	ASO900561	CRINKLE WASHER	1
15	ASK5803031013	SNAP RING I40	1
16	ASO900553	CENTRIFUGAL SWITCH (ROTATING) 50HZ 7	1
17	ASO900562	MOTOR SPACER-FLEXISAND	1
18	ASO900557	STEEL DOG CLUTCH	1
19	ASK5801130810	SCREW 4.8x31.5 H.S.H.C.UNF THR.1"	6
20	ASK3199940055	MOTOR COMPLETE ANGLED PLUG 4P+1 - F	1
21	ASK5801130809	SCREW 5/16 UNC 7/8 H.S.H.C.ALL THR.	8

*ASK3100030703 Stator Flexisand 1900 230/50 (for Flexisand 1.9 with fixed cable connection)

	P/N machine:	AMO310002	Page:	5	
	Description:	FLEXISAND 1900W 230V/50HZ	Edition:	2022	